

HONDALINE®

*Excluded
Headlight*

*Not Included
Paint & Assembly
20710*

INSTRUCTION MANUAL

FAIRING KIT FOR CB900C(C)

MANUEL D'INSTRUCTION

KIT DE CARENAGE POUR LA CB900C(C)

'82

CB900C(C) FAIRING KIT

NOTE: This fairing is designed for use only on the CB900C(C) motorcycle.

The following steps are necessary to install this kit on your motorcycle: 1) Re-routing of the headlight circuits, 2) Removal and re-installation of the oil cooler and 3) Adjustment and inspection of the installation.

Improper installation or adjustment of any of the above may create an unsafe vehicle. In order to prevent improper installation, we urge you to have the kit installed by your Honda Dealer.

PARTS LIST

Index No.	Part Name	Q'ty
①	Nut, hex, 8 mm	2
②	Washer, lock, 8 mm	2
③	Cover, holder	1
④	Coupler holder	1
⑤	Bolt, flange, 8 x 20 mm	2
⑥	Holder, coupler holder bracket	2
⑦	Bracket, coupler holder, Left	1
⑧	Bracket, coupler holder, Right	1
⑨	Front fairing set bolt	4
⑩	Collar, front fairing set	4
⑪	Washer, spring, 6 mm	4
⑫	Nut, hex, cap, 6 mm	4
⑬	Upper fairing bracket A, Right	1
⑭	Upper fairing bracket A, Left	1
⑮	Set bolt	2
⑯	Nut, flange, 6 mm	4
⑰	Washer, fairing	8
⑱	Screw, pan, 6 x 16 mm	8
⑲	Lower fairing rubber	2
⑳	Nut, cap, 6 mm	4
㉑	Bolt, flange, 8 x 20 mm	2
㉒	Fairing set plate	2
㉓	Bolt, flange, 6 x 20 mm	4
㉔	Lower fairing bracket, Left	1

Index No.	Part Name	Q'ty
㉕	Lower fairing bracket, Right	1
㉖	Bolt, flange, 10 x 75 mm	1
㉗	Bolt, flange, 10 x 55 mm	1
㉘	Washer, plain	2
㉙	Circlip, handlebar weight	2
㉚	Rubber, handlebar weight	4
㉛	Handlebar weight	2
㉜	Front cover	1
㉝	Front cover bracket	1
㉞	Upper fairing bracket B	1
㉟	Upper fairing bracket band	2
㊱	Bolt-washer, 6 x 20 mm	2
㊲	Sub wire harness F	1
㊳	Meter visor	1
㊴	Washer, plain, 4 mm	1
㊵	Screw, pan head, 4 x 25 mm	1
㊶	Caution label, tire	1
㊷	Wire band B	2
㊸	Wire band	1
㊹	Sub wire harness C	1
㊺	Sub wire harness B	1
㊻	Bolt, meter visor A	2
㊼	Caution label, tire	1

Fig. 1

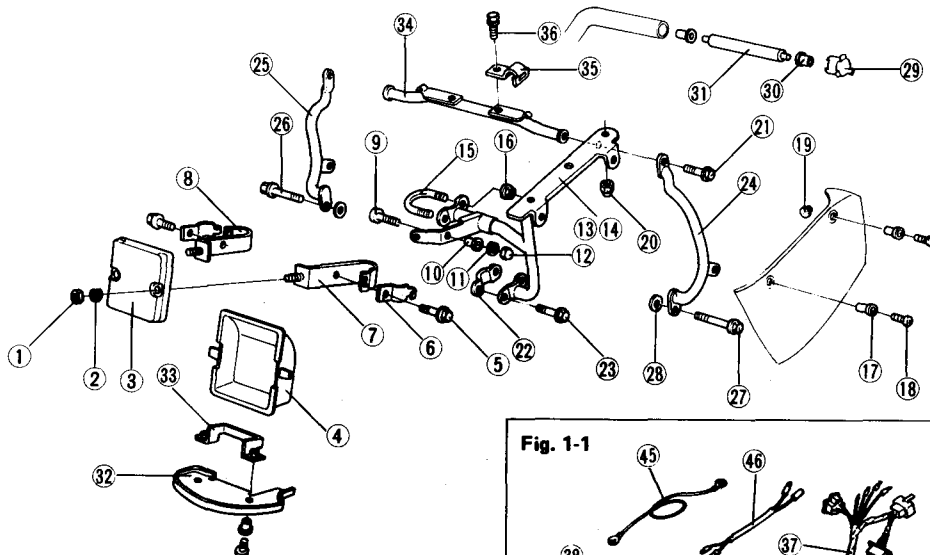
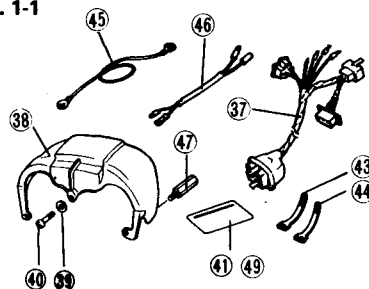
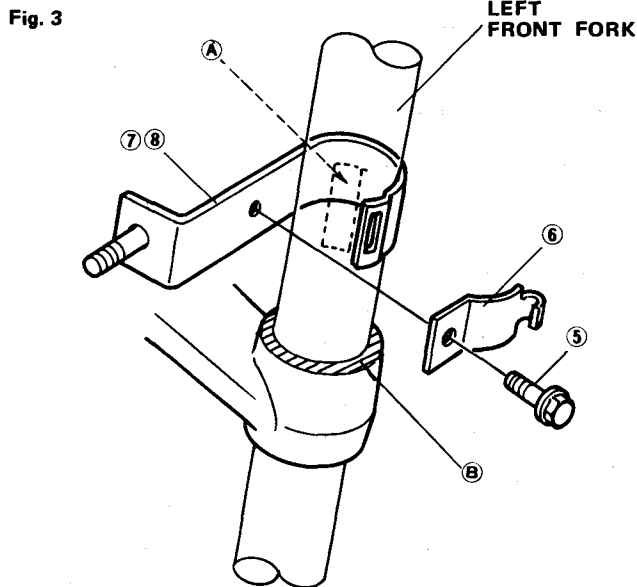

Fig. 1-1



FAIRING MOUNT INSTALLATION

- 1) Position the coupler holder brackets (7) and (8) and holders (6) on the front forks and loosely install using an 8 x 20 mm flange bolt (5) for each.



- 2) Re-route the ignition switch wires as follows:

- a. Disconnect the ignition switch connector.
- b. Connect the sub wire harness F (37) connector to the ignition switch connector.

NOTE: Disconnect the ignition switch wire coupler and attach the bracket to the ignition switch wire coupler of the sub wire harness F (37) with the pan head screws. Connect the wire couplers.

Fig. 4-1

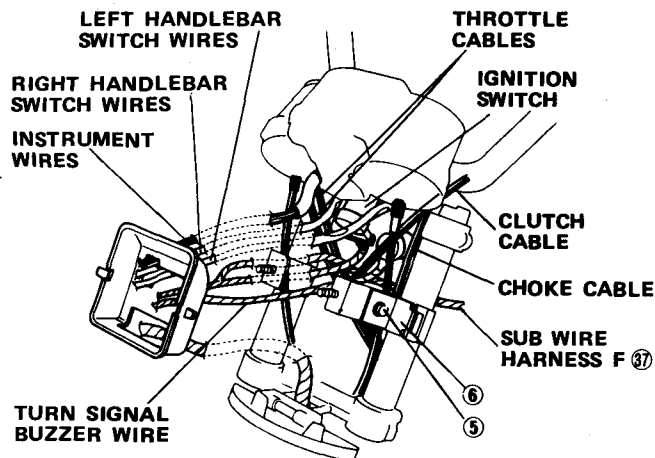
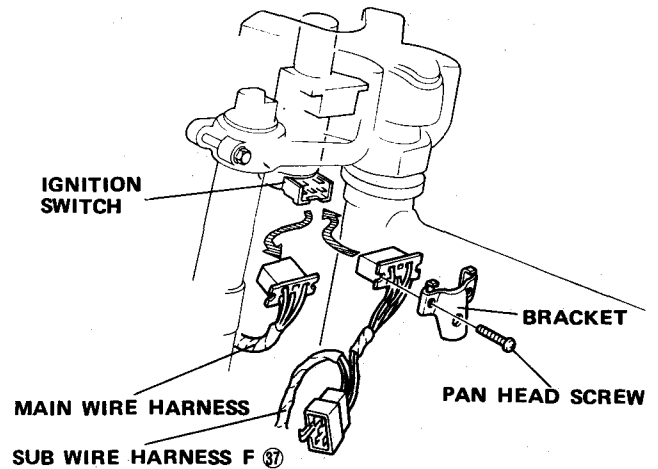

Fig. 4-2



- 3) Route the wire harnesses through the upper and lower holes of the wire harness coupler holder (4) as shown. Insert the lugs on the connector holder (20) into holes in the coupler holder brackets (7) and (8) install the coupler holder (4) using two 8 x 25 mm flange bolts (6).

NOTE: Tighten the flange bolts to the specified torque.

Fig. 4-3

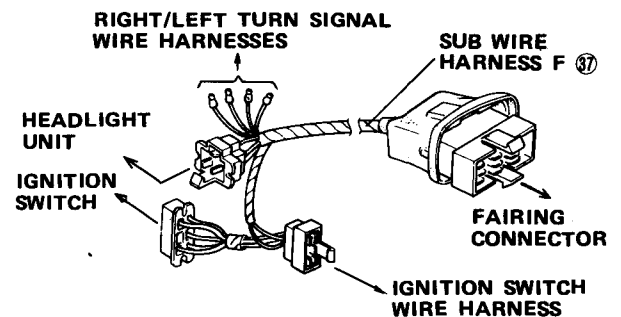

- 4) Connect all wires to wire harness color-to-color inside the coupler holder (4), place the wire connectors as shown and secure the wires with a wire band B (43). Note that connect the light blue/white and brown wire of the sub wire harness F (37) to the light blue/white wire of the right turn signal.

NOTE:

- Check that the connectors are connected securely.
- Re-check the routing before going to the next step.

- Neatly arrange the wires inside the coupler holder ④ before installing the cover.

Fig. 5

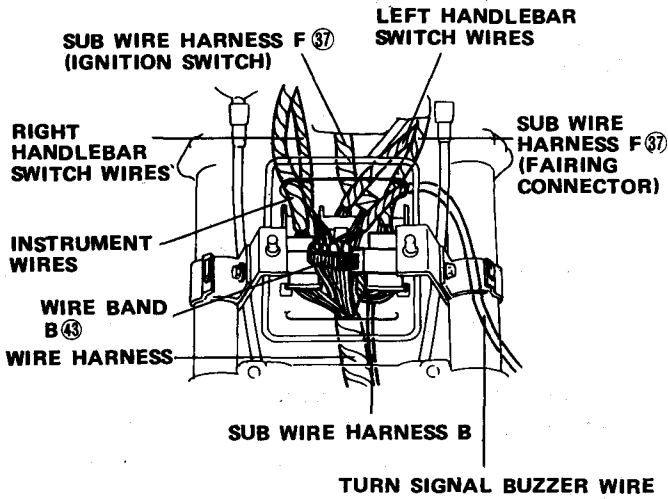

- 5) Secure the sub wire harness F ③⑦ with the wire bands ④③ and ④④ furnished with the fairing. (The band ④④ is longer than the band ④③.)

Fig. 6

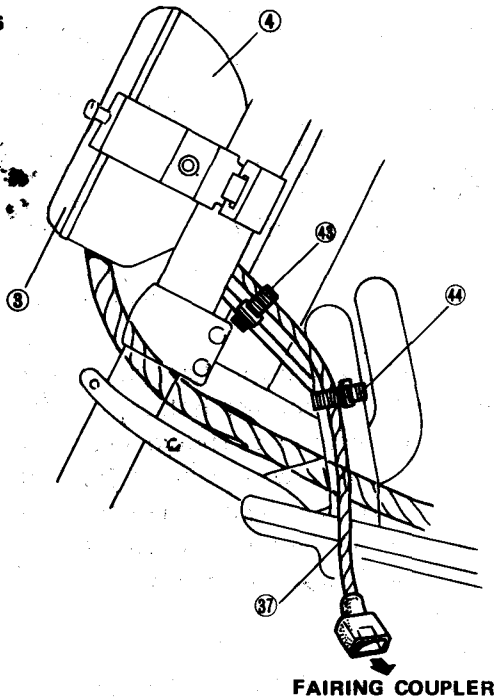

- 6) Install the holder cover ③ as follows: Position the holder cover ③ on the coupler holder brackets ⑦ and ⑧ and install using an 8 mm nut ① and lock washer ② for each bracket. Tighten the nuts securely.

NOTE: Make sure that the wires are not pinched between the holder cover ③ and brackets.

Tighten the nuts to the specified torque.

- 7) Install the meter visor. (Fig. 7)

- a. Remove and retain the 6 mm cap nuts ① and 6 mm lock washers.
- b. Install the bolts ④⑦ on the meter studs ③ and tighten securely.
- c. Remove and discard the 4 x 8 mm screw ⑤.
- d. Position the meter visor over the meters and install using the 4 mm plain washers ③⑨, 4 x 25 mm screw ④⑩, 6 mm lock washers ③ and 6 mm cap nuts ①.

Fig. 7

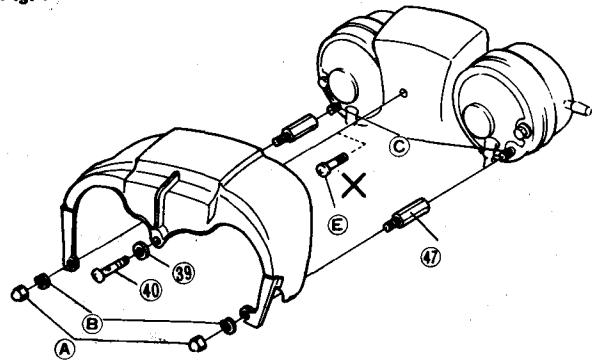

8) Remove the oil cooler to facilitate installation of the fairing mount brackets.

NOTE:

- Do not exert pressure to the oil lines.
- Do not damage the oil lines.
- a. Remove the clip pin (A).
- b. Remove the two 6 mm plain washers (B) and 6 mm cap nuts (C) and disconnect the oil lines. Remove the oil cooler by carefully lowering it down.

Fig. 8

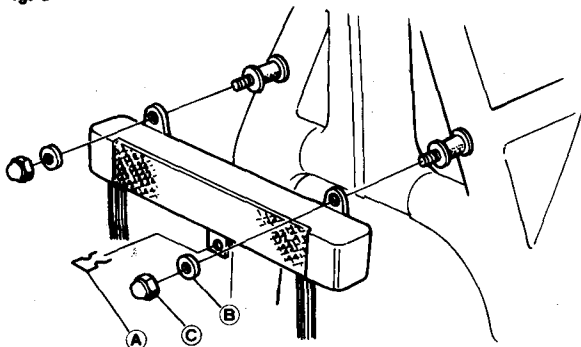

9) Install the fairing and cowl brackets.

- a. Remove and discard the 10 x 45 mm flange bolts (A) and (B).
- b. Position the right and left upper fairing brackets A (13) and (14) on the frame and install using a bolt (15), two 6 mm flange nuts (16), a set plate (22) and two 6 x 20 mm flange bolts (23) for each. Do not tighten at this time.

NOTE: Route the subwire harness C (45) as shown. Install the set bolt (15) by first tightening the nuts 6 mm (16) (C) and (16) (D) evenly and then torquing only the nut (16) (C) to the specified tension.

- c. Loosely install the upper fairing bracket B (34) using the two bands (35) and two 6 x 20 mm bolt/washer combinations (36).

NOTE: Engage the band (35) with the hook of the upper cowl bracket B (34).

- d. Loosely install the right and left lower fairing brackets (25) and (24) using the plain washers (28), 10 x 75 mm flange bolts (26) and 10 x 55 mm flange bolts (27).
- e. Check that the upper fairing brackets A (13) and (14) (step b), upper fairing bracket B (34) (step c), and lower fairing brackets (25) and (24) (step d) are

properly positioned. Provisionally tighten the 8 x 20 mm flange bolts (21).

Fig. 9-1

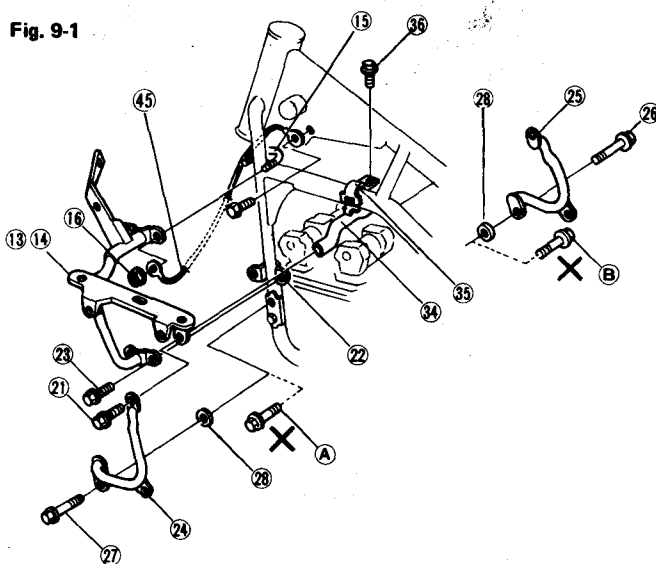

Fig. 9-2

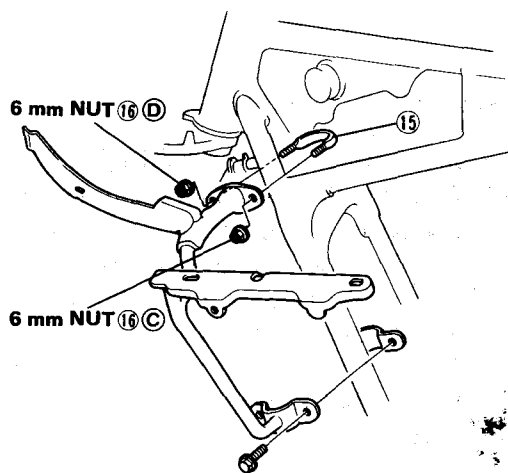
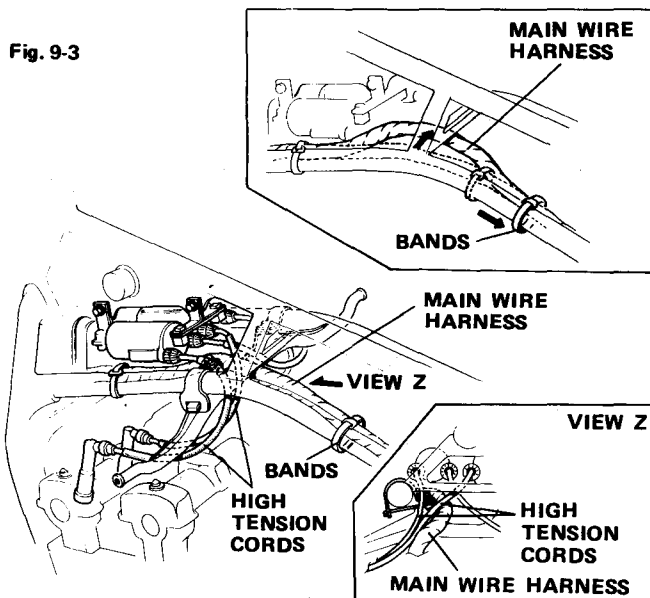
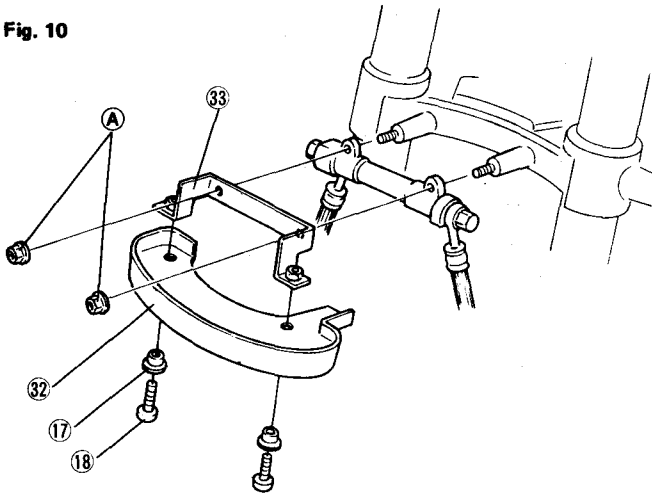

Fig. 9-3



- 10) Install the front cover as follows:
- Position the front cover bracket ③③ on the fork bottom bridge and install using the two 6 mm flange nuts ①.
 - Position the front cover ③② on the bracket ③③ and install using the two washers ①⑦ and 6 x 16 mm screws ①⑧.

Fig. 10



FAIRING AND WINDSHIELD

- 1) Install the headlight on the fairing.
- Remove the headlight mount assembly ① from the fairing.
 - Remove the two 3 x 12 mm screws from the mount assembly ① and install the headlight unit as shown. Connect the socket to the headlight.
 - Install the headlight assembly on the fairing.

Fig. 11

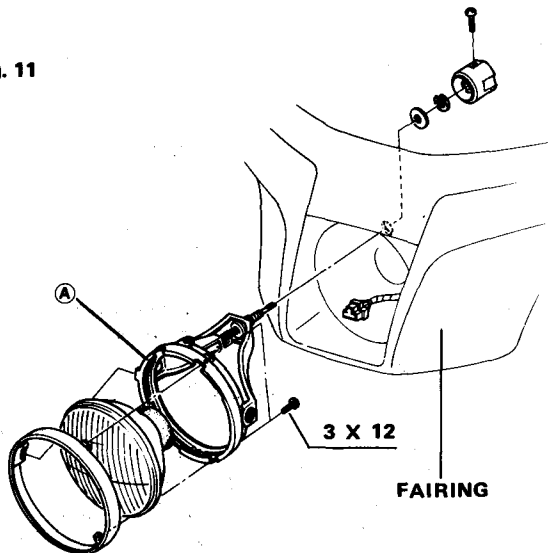

- 2) Install the fairing on the fairing bracket installed in step 9 as follows (Do not disturb the sequence shown):

- Position the right and left fairing nut plates ① and ② on the four fairing aligning holes in the fairing with the holes in the mount ①. Install 6 mm cap nuts ②① on the studs, but do not tighten at this time.
- Attach the fairing to the upper fairing brackets using bolts ⑨, collars ⑩, 6 mm lock washers ①①, and 6 mm cap nuts ①②.

NOTE:

- Tighten all bolts and nuts to the specified torques.
 - Turn the handlebar right and left fully.
- c. Tighten the cap nuts ②① to the specified torque.

Fig. 12

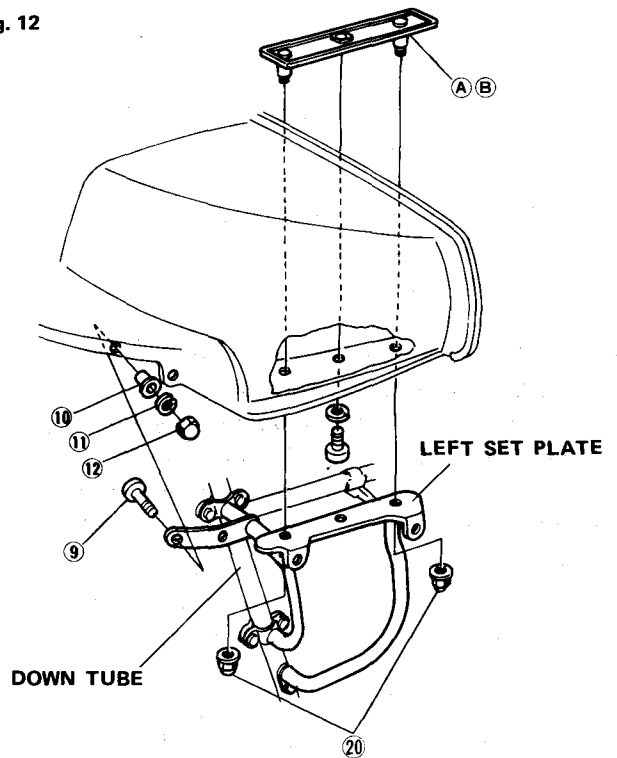

3) Tighten the left and right upper fairing brackets A ⑬ and ⑭, upper fairing bracket B ⑳, and left and right lower fairing brackets ㉕ and ㉔. (Fig. 9-1)

NOTE: Tighten the set bolts ⑮ and fairing set plate ㉒ evenly.

4) Install the left and right lower fairing sections.

a. Press the rubbers ⑲ into holes in the left and right lower fairing sections.

b. Install the fairing sections using the washers ⑰ and 6 x 16 mm screws ⑱.

Fig. 13

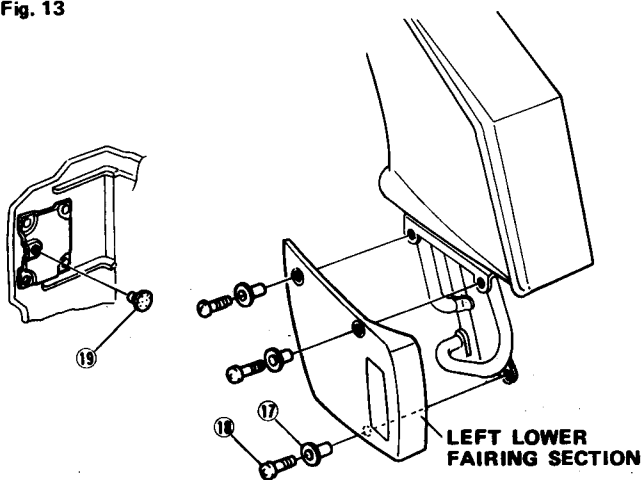

5) Reinstall the oil cooler. (Fig. 8)

6) Reinstall the fuel tank.

7) Retighten all bolts and nuts. Connect the sub wire harness ⑆ to the wire harness connector inside the fairing.

8) Reconnect the battery ground cable to the battery negative terminal.

9) Fill the front forks to the recommended air pressure, 1.1 kg/cm² (16 psi).

NOTE:

- Refer to the Owner's Manual.
- Check for leaks by applying soapy water around the valve and valve joint.

10) Remove the handlebar upper holder and pull it up, exercising care not to damage the wires.

11) Reinstall the handlebar upper holder.

12) Install the windshield as follows:

a. Remove the six bolts ①, windshield trim ② collars ③ and special nuts ④.

b. Install the windshield on the fairing as shown:

- Handlebar mirror equipped model:

Use the six bolts ①.

- Fairing mirror equipped model:

Use the two bolts ① and four mirror bolts.

NOTE:

- Remove the mirrors from the handlebar when the fairing is equipped with the mirrors.

- Press the grommets furnished with the fairing into the holes left by the mirrors.

Fig. 14

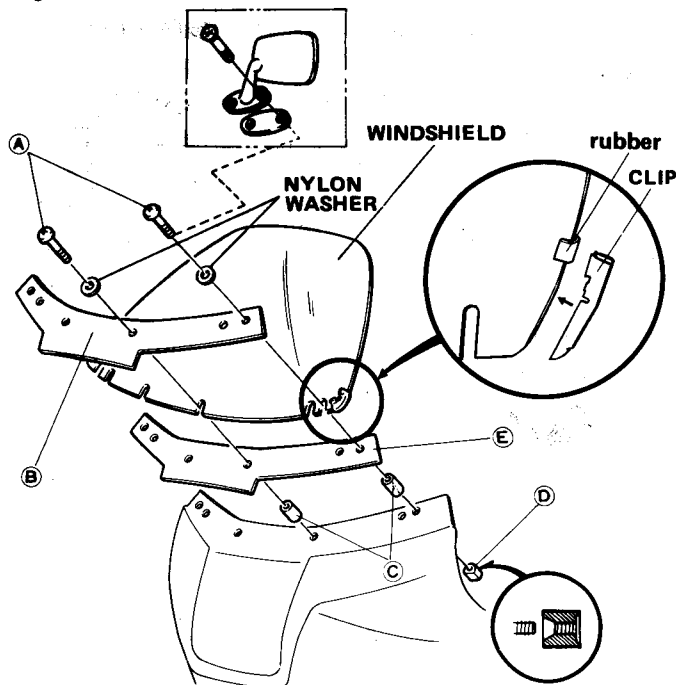

13) Install the handlebar weights. (Fig. 15-1, 15-2)

- Remove the right and left handlebar grip rubbers.
- Install the rubber (30) and circlips (29) on the weights (31).
- Press the weights (31) into the holes of the handlebars and secure with the circlips (29).
- Apply the adhesive to each grip area of handlebars and slide the grip rubbers onto the handlebars.

Fig. 15-1

LEFT HANDLEBAR GRIP RUBBER

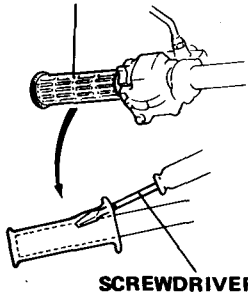

RIGHT HANDLEBAR GRIP RUBBER

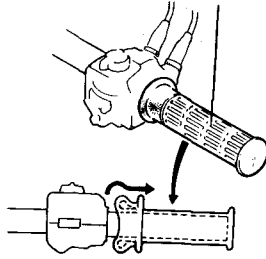
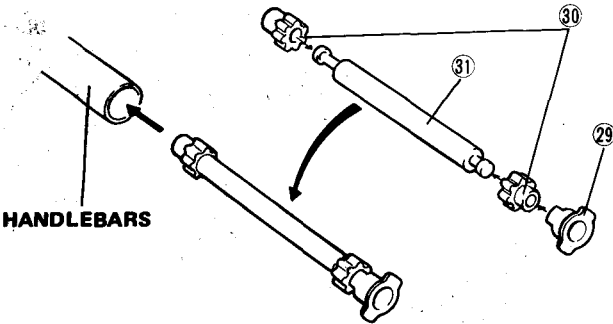

Fig. 15-2



14) Attach the caution labels as follows:

Attach the labels with the top in the arrow direction.

Name	Description
<p>WINDSHIELD SCREEN CAUTION LABEL</p>	<p>Fig. 16</p>
<p>TIRE CAUTION LABEL</p>	<p>Fig. 17</p>

PRE-DELIVERY SERVICE CHECK LIST

NOTE: Check all items listed on the following Pre-delivery Service Check List. Refer to Owner's manual or shop manual for specifications and detailed procedures. Always test ride the unit to make sure that it is functioning properly.

- Check operation of front brake.
- Adjust clutch, check cable routing, and check operation.
- Adjust mirrors.
- Check choke operation and adjust idle speed.
- Check throttle grip free play, cable routing, and operation in all steering positions.
- Check tire pressure.
- Check operation and air pressure of front suspension.
- Inspect electrical components for proper operation and adjustment:
 - Headlight: Adjust high and low beam aim, and check high beam pilot light.
 - Turn signals.
 - Air pressure warning light.
 - Horn.
 - Engine stop switch.
 - Starter.
 - Instrument, flasher, oil pressure, headlight and neutral indicator lights.
- Check security of all nuts, bolts, and other fasteners.
- Check to ensure all applicable recall and product update campaigns are complied with.
- TEST RIDE:** Check performance, handling, and operation:
 - Acceleration: Smoothness, etc.
 - Cruising: Smoothness, etc.
 - Handling: Stability and cornering.
 - Brakes: Smoothness and stopping power.
 - Idling: Smoothness, throttle response, return to idle.
 - Recheck idle speed after 10 minutes of stop and go driving.
 - Speedometer and Tachometer: Proper operation.
 - Upon completion of test ride, check for fuel, oil, or coolant leaks; check fan operation.

RULES FOR SAFER RIDING

Follow all safety notes and precautions described in the owner's manual and Owner's Instructions.

The weight of the accessory is shown below:

Weight added to motorcycle	14.0 kg (31 lbs)
----------------------------	------------------

The overall weight added to the motorcycle is what concerns the rider. It is this weight that must be added to the total of the rider and cargo weights to be sure the vehicle load limit is not exceeded.