



| | |
|----------------------|------|
| SERVICE INFORMATION | 20-1 |
| TROUBLESHOOTING | 20-1 |
| STARTER MOTOR | 20-2 |
| STARTER RELAY SWITCH | 20-5 |

SERVICE INFORMATION

GENERAL

- The starter motor can be removed with the engine in the frame.

SPECIFICATIONS

| | | STANDARD | SERVICE LIMIT |
|---------------|----------------------|----------------------------------|------------------|
| Starter motor | Brush spring tension | 560 g – 680 g (19.75 – 23.99 oz) | 560 g (19.75 oz) |
| | | 12.0 – 13.0 mm (0.47 – 0.51 in) | 7.5 mm (0.30 in) |

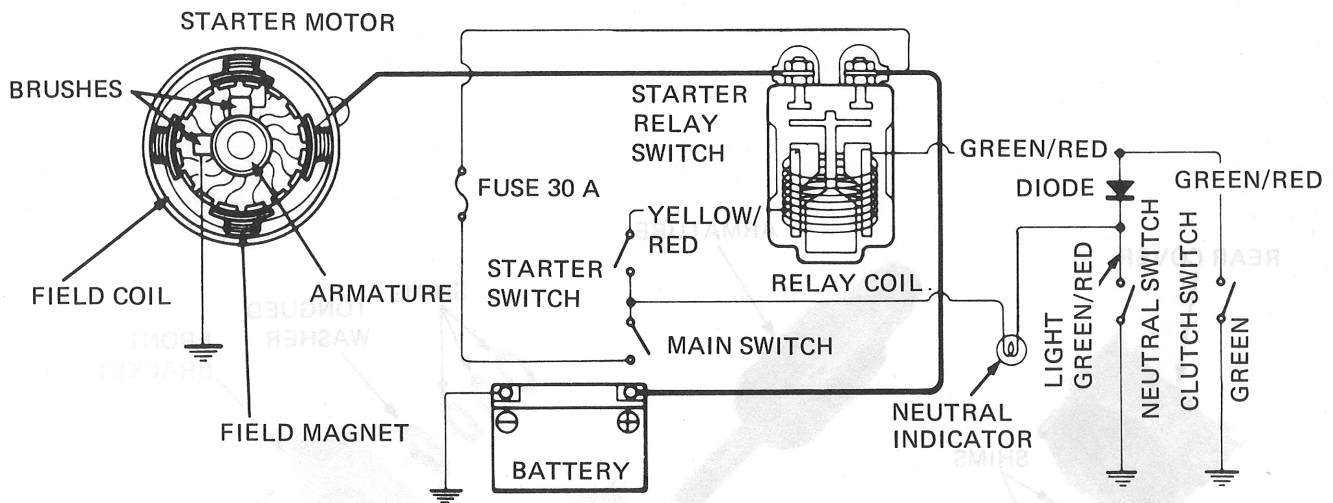

TROUBLESHOOTING

Starter motor will not turn:

1. Battery discharged.
2. Faulty ignition switch.
3. Faulty starter switch.
4. Faulty neutral switch.
5. Faulty starter relay switch.
6. Loose or disconnected wire or cable.
7. Neutral diode open.

Starter motor turns engine slowly:

1. Low specific gravity.
2. Excessive resistance in circuit.
3. Binding in starter motor.

Starter motor turns, but engine does not turn:

1. Faulty starter clutch.
2. Faulty starter motor gears.
3. Faulty starter motor or idle gear.

Starter motor and engine turns, but engine does not start:

1. Faulty ignition system.
2. Engine problems.



STARTER MOTOR

REMOVAL

WARNING

With the ignition switch OFF, remove the negative cable at the battery before servicing the starter motor.

Remove the right frame side cover and disconnect the starter cable at the starter relay switch.

Remove the starter motor cover and starter motor.

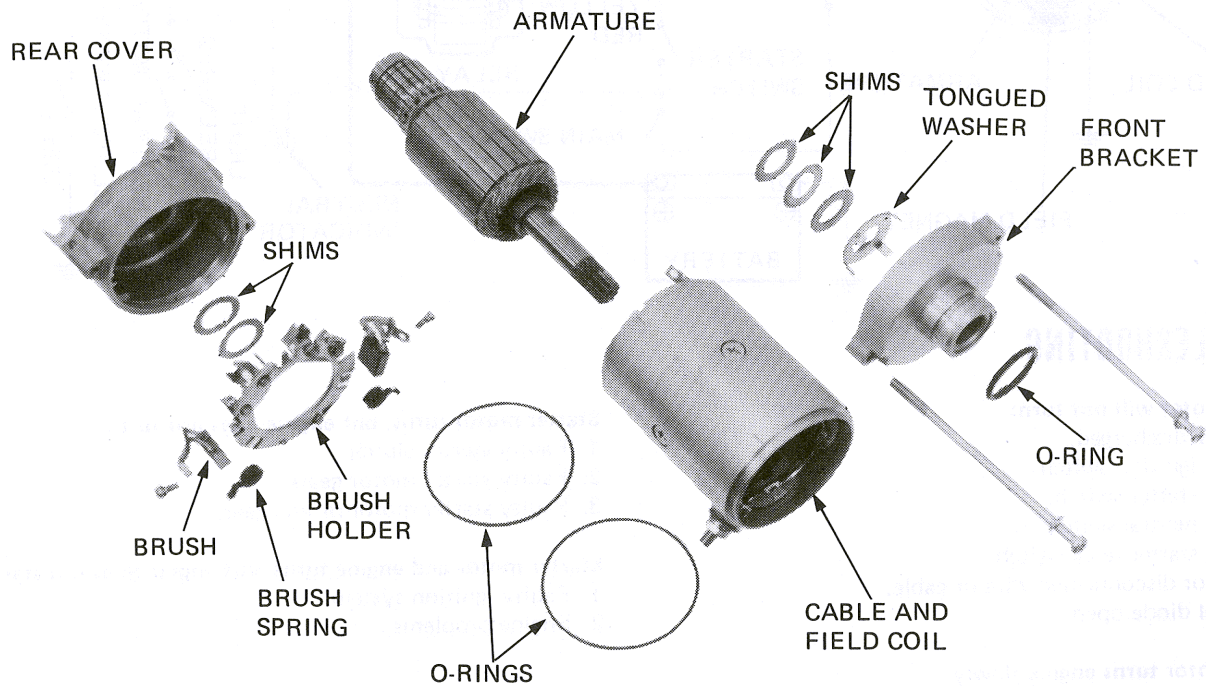
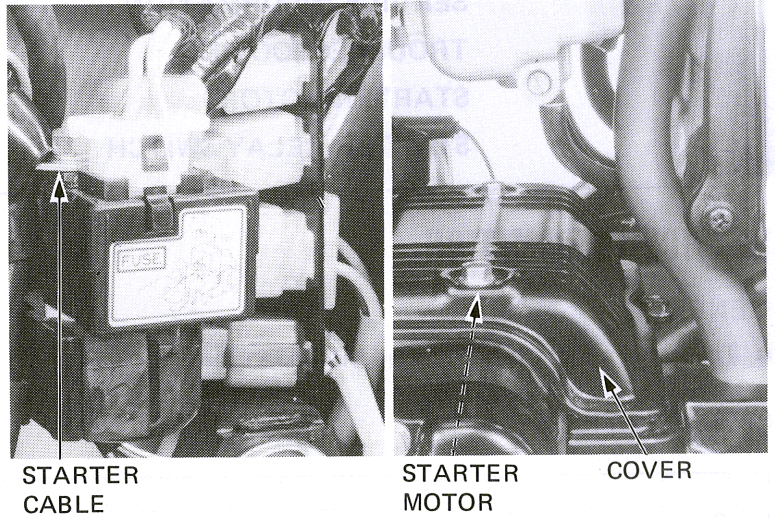



BRUSH INSPECTION

Remove the starter motor case screws.
Inspect the brushes and measure the brush length.
Measure brush spring tension with a spring scale.

SERVICE LIMITS:

Brush length: 7.5 mm (0.30 in)
Brush spring tension: 560 g (19.75 oz)

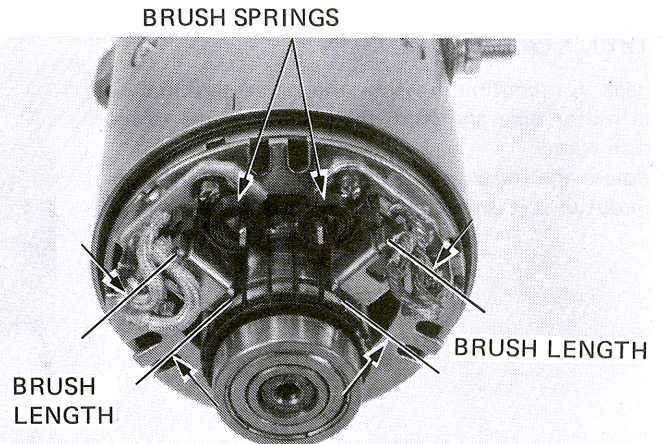

COMMUTATOR INSPECTION

Remove the starter motor case.

NOTE

Record the location and number of thrust washers.

Inspect the commutator bars for discoloration.
Bars discolored in pairs indicate grounded armature coils.

NOTE

Do not use emery or sand paper on the commutator.

COMMUTATOR

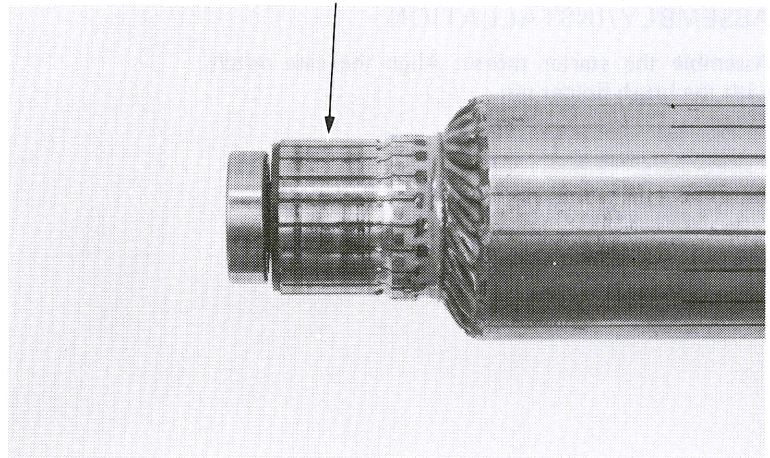

COMMUTATOR BAR PAIRS CONTINUITY: NORMAL

Check for continuity between pairs of commutator bars, and also between commutator bars and armature shaft.

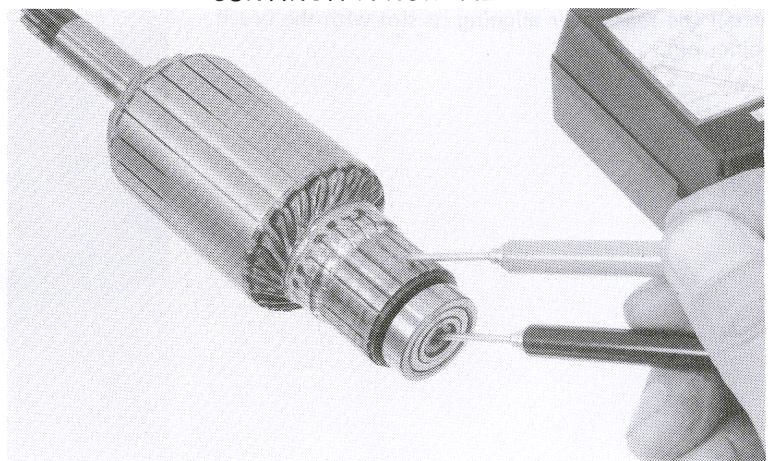

ARMATURE-SHAFT NO CONTINUITY: NORMAL



ELECTRIC STARTER

FIELD COIL INSPECTION

Check for continuity from the cable terminal to the motor case and from the cable terminal to the brush wire.

Replace the starter motor if the field coil is not continuous or if it is shorted to the motor case.

CABLE TERMINAL—MOTOR CASE
NO CONTINUITY: NORMAL

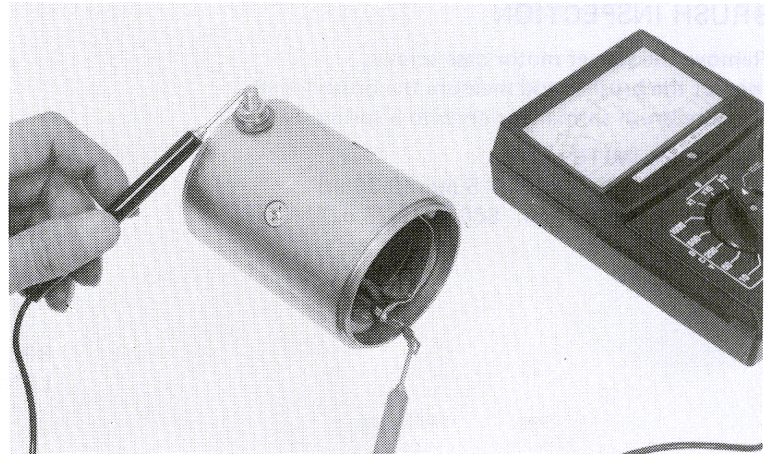

CABLE TERMINAL—BRUSH WIRE
CONTINUITY: NORMAL

ASSEMBLY/INSTALLATION

Assemble the starter motor. Align the case notch with the brush holder pin.

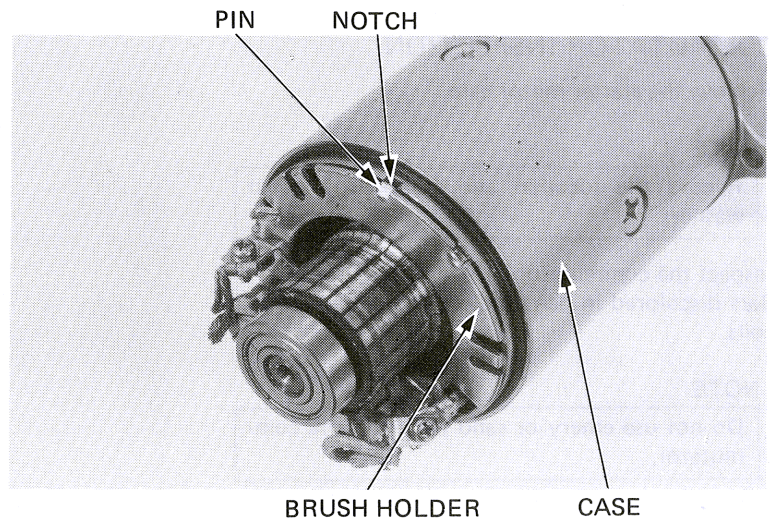

Install the rear cover aligning its slot with the brush holder pin.

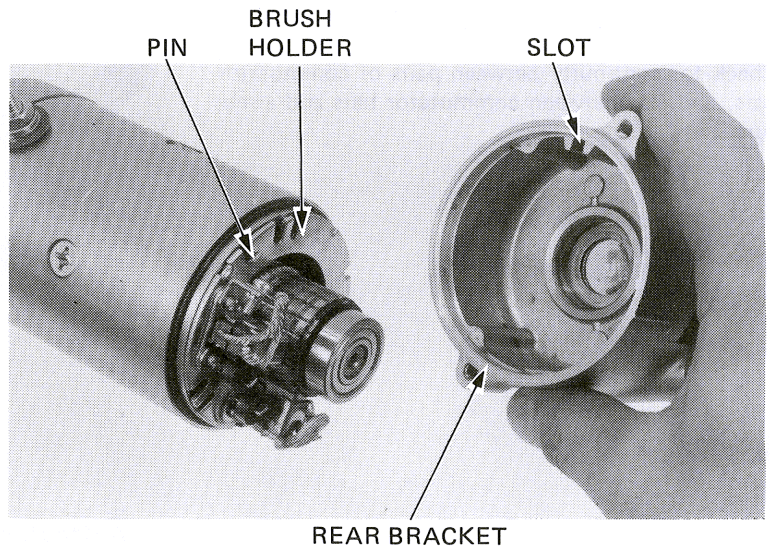



STARTER RELAY SWITCH

INSPECTION

Depress the starter switch button with the ignition ON. The coil is normal if the starter relay switch clicks.

Connect an ohmmeter to the starter relay switch terminals.

Connect a 12 V battery to the switch cable terminals.

The switch is normal if there is continuity.

